

# How to Connect KOBE Free Wi-Fi

KOBE Free Wi-Fiの接続方法  
Connection method of KOBE Free Wi-Fi



※Please acknowledge that there is a potential risk of interception of your wireless communications as the Wi-Fi network is not secured with encryption.

※The Wi-Fi you use: Communication of a network isn't coded, and there is a fear that you intercept communication. When accepting it beforehand, would you use it?

## STEP 1 Wi-Fi settings

Wi-Fi of a terminal Setting

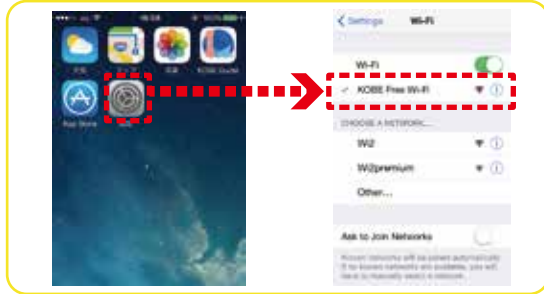

Select SSID (wireless network): KOBE Free Wi-Fi on your Wi-Fi setting screen.

A Wi-Fi KOBE Free Wi-Fi is chosen on the setting screen.

## STEP 2 Open the web browser for Authentication

Start of a browser

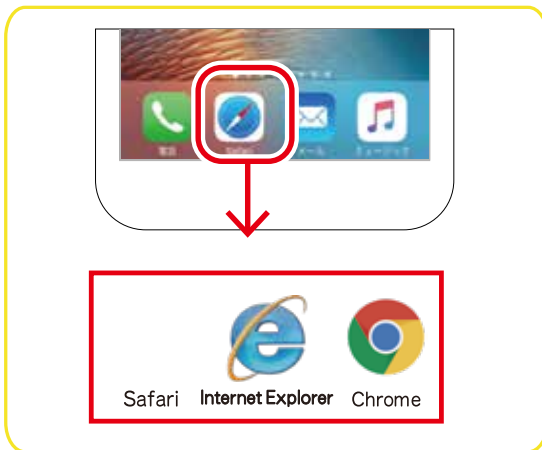

Open the web browser and access to the Internet.

Please start a browser and access the internet.

## STEP 3 Select Login method

Choice of login method



On the terms of service screen, select your preferred login method, either "Log-in with SNS account authentication" or "Log-in with email address authentication".

On the agreement screen "By SNS account authentication, login" or "Please choose one of them of 'by e-mail address authentication, login'".

## STEP 4-1 When SNS account authentication is selected

SNS When an account is used. ※Yahoo! JAPAN ID can also be used.



- ① Enter your SNS account (ID, password) and activating your account.
- ② After authentication is completed, "KOBE Free Wi-Fi" is available.

(1) The user's SNS An account (the ID and password) is input. (2) After authentication completion, "KOBE Free Wi-Fi" can be used.

## STEP 4-2 When email address authentication is selected

When e-mail address is used.

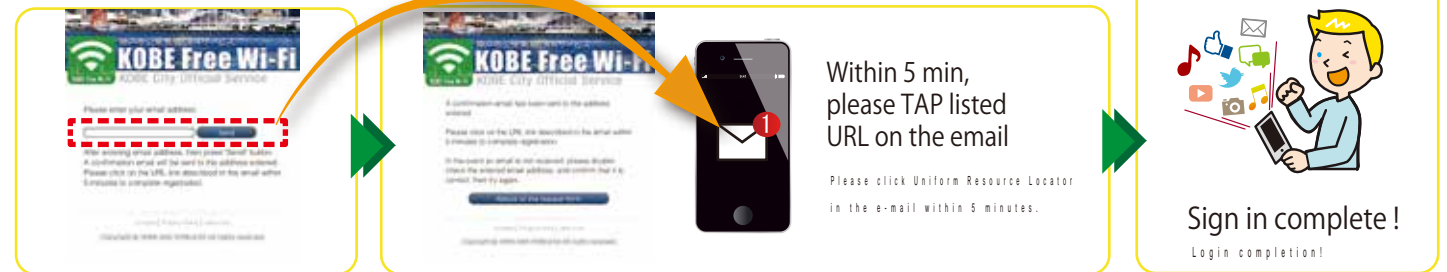

- ① Enter your email address to temporarily register.
- ② An email with a URL link for main registration is sent to the registered email address.
- ③ Click the link to complete main registration. KOBE Free Wi-Fi is available.

(1) The user's e-mail address is input and it's registered temporarily. (2) A link destination for registration is indicated on the mail body which is sent to the e-mail address registered temporarily.

(3) Registration is completed by clicking a link destination, and "KOBE Free Wi-Fi" can be used.